

Flange Mounted Brake

Model

● 305



▶ Flange Mounted
▶ Spline Drive

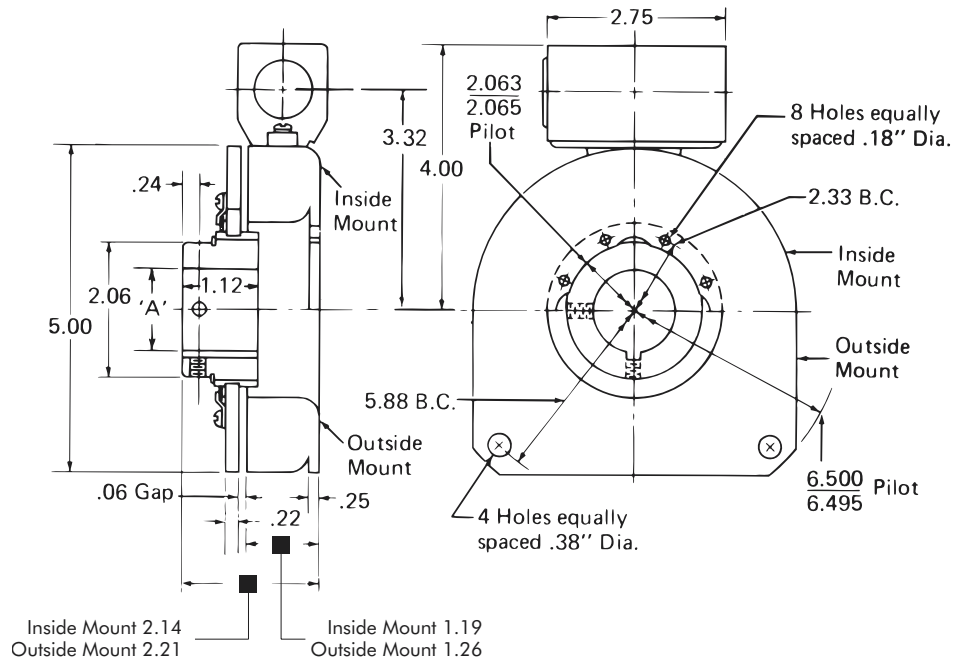

Bore "A"	Keyway
3/4"	.187 x .094
7/8"	.187 x .094
1"	.250 x .125
1-1/8"	.250 x .125
1-1/4"	.250 x .125

Technical Data and Torque (In. Lb.)

Model No.	Wt. Lbs.	Static Torque in. lb.	Max. Speed RPM	Coil Voltage vdc	* Rated Current amps	RPM									
						0	300	600	900	1200	1500	1800	2400	3000	3600
305	5.1	684	3600	90	.41	684	624	564	516	468	420	384	324	288	252

* Rated current at 90v.

Customer must maintain:

1. Concentricity between mounting flange and shaft within .010.
2. Perpendicularity between mounting surface and shaft within .010.

Refer to Section M for torque and heat dissipation curves.

Order Parts for Assembly No. FC305054 and FC305055

	Armature Plate Assembly	Magnet Accessory	Armature Hub Assembly					FC305054		FC305055	
			Bore					Magnet		Inside Mount	Outside Mount
			3/4"	7/8"	1"	1-1/8"	1-1/4"				
24 Volts	305396-1	326143	305453-1	305453-2	305453-3	305453-4	305453-5	305343	305353		
90 Volts	305396-1	326143	305453-1	305453-2	305453-3	305453-4	305453-5	305344	305354		

To order, specify: 1, Armature Plate Assembly
1, Magnet Accessory
1, Armature Hub Assembly of required Bore size
1, Magnet of required Voltage for either Inside Mount or Outside Mount

For controls, see Section K.

Flange Mounted Brake – Replacement Parts

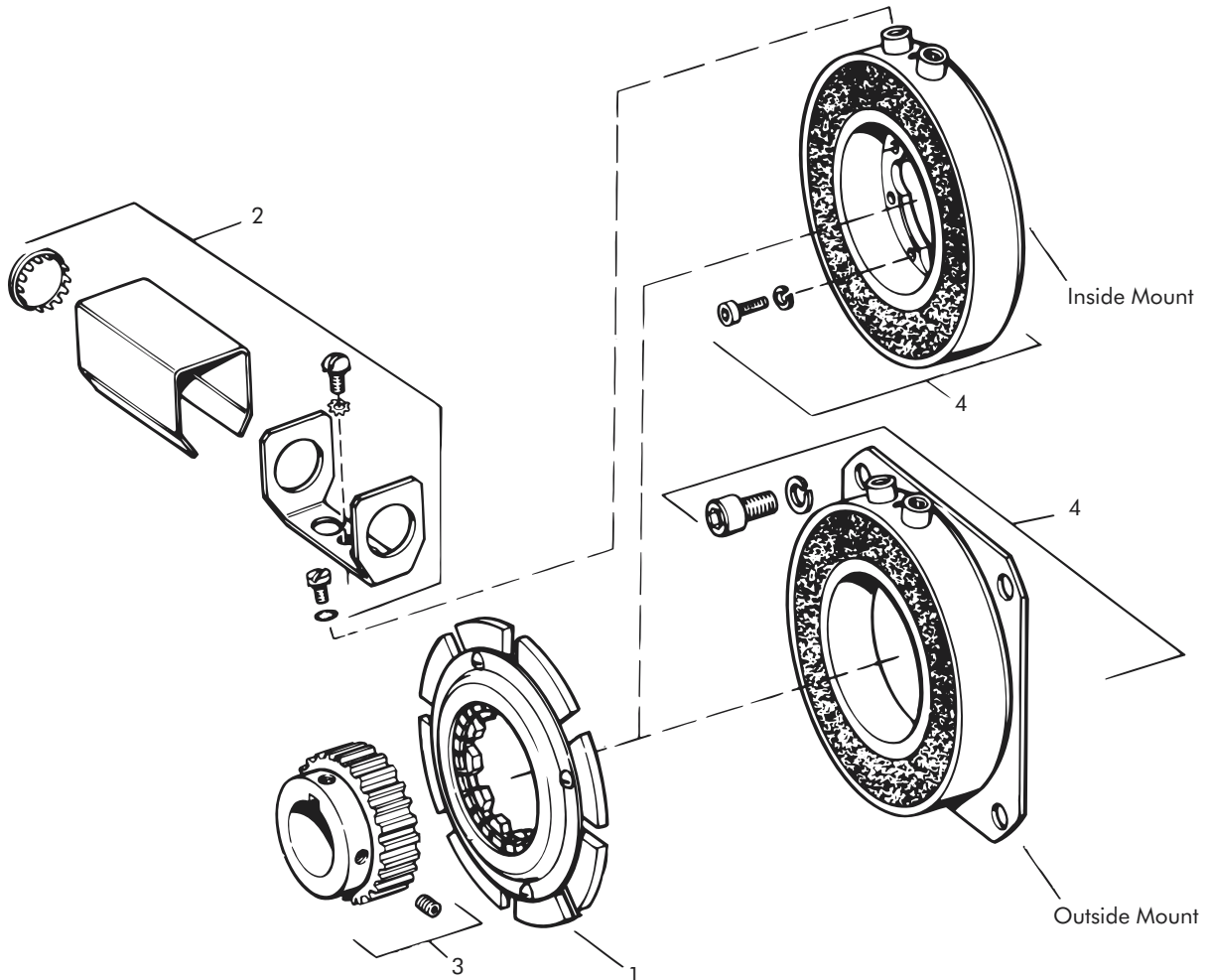

Replacement Parts

Item	Qty.	Description	Part No.	Item	Qty.	Description	Part No.
1	1	Armature Plate Assy. (24 Teeth)	305396-1	4	1	Magnet	
2	1	Magnet Accessory	326143			24 Volts, Inside mounted	305343
3	1	Armature Hub Assembly				90 Volts, Inside mounted	305344
		3/4" Bore	305453-1			24 Volts, Outside mounted	305353
		7/8" Bore	305453-2			90 Volts, Outside mounted	305354
		1" Bore	305453-3				
		1-1/8" Bore	305453-4				
		1-1/4" Bore	305453-5				