

# Clutch Coupling

Model

● 308

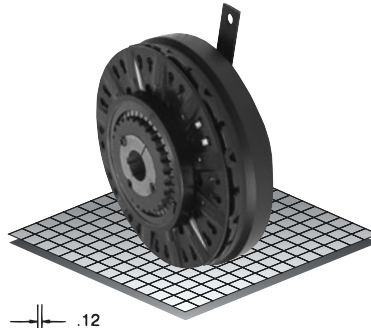

- ▶ Stationary Field
- ▶ Bearing Mounted
- ▶ Spline Drive

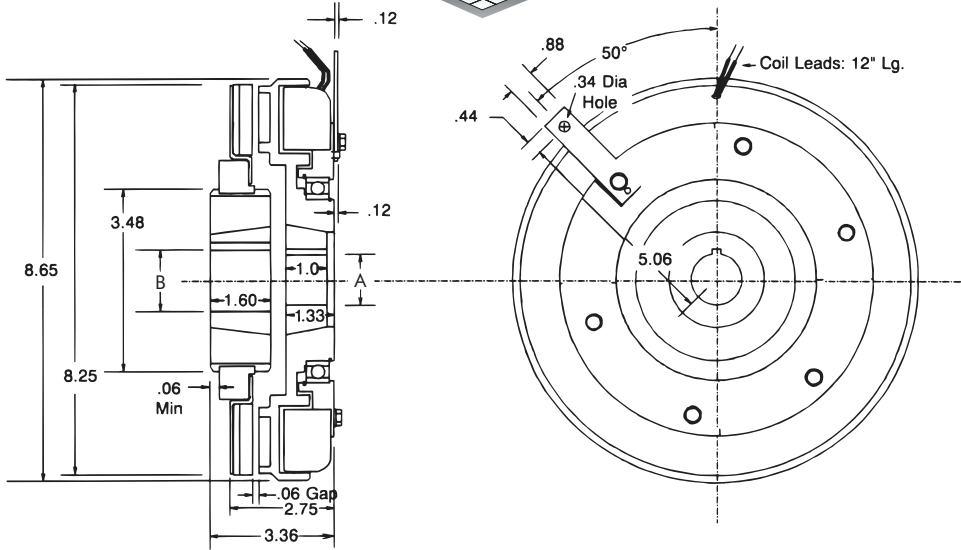

**Bushing 1615**

Bore "B"	Keyway	Part No.
1/2"	.500 .125 x .062	326015 - 1
9/16"	.562 .125 x .062	326015 - 2
5/8"	.625 .187 x .093	326015 - 3
11/16"	.687 .187 x .093	326015 - 4
3/4"	.750 .187 x .093	326015 - 5
13/16"	.812 .187 x .093	326015 - 6
7/8"	.875 .187 x .093	326015 - 7
15/16"	.937 .250 x .125	326015 - 8
1"	1.000 .250 x .125	326015 - 9
1-1/16"	1.062 .250 x .125	326015 - 10
1-1/8"	1.125 .250 x .125	326015 - 11
1-3/16"	1.187 .250 x .125	326015 - 12
1-1/4"	1.250 .250 x .125	326015 - 13
1-5/16"	1.312 .312 x .156	326015 - 14
1-3/8"	1.375 .312 x .156	326015 - 15
1-7/16"	1.437 .375 x .187	326015 - 16
1-1/2"	1.500 .375 x .187	326015 - 17
1-9/16"	1.562 .375 x .187	326015 - 18
1-5/8"	1.625 .375 x .187	326015 - 19
*1-3/8"	1.375 .375 x .125	326015 - 20
*1-5/8"	1.625 .375 x .125	326015 - 21

**Bushing 1610**

Bore "A"	Keyway	Part No.
1/2"	.500 .125 x .062	326642 - 1
9/16"	.562 .125 x .062	326642 - 2
5/8"	.625 .187 x .093	326642 - 3
11/16"	.687 .187 x .093	326642 - 4
3/4"	.750 .187 x .093	326642 - 5
13/16"	.812 .187 x .093	326642 - 6
7/8"	.875 .187 x .093	326642 - 7
15/16"	.937 .250 x .125	326642 - 8
1"	1.000 .250 x .125	326642 - 9
1-1/16"	1.062 .250 x .125	326642 - 10
1-1/8"	1.125 .250 x .125	326642 - 11
1-3/16"	1.187 .250 x .125	326642 - 12
1-1/4"	1.250 .250 x .125	326642 - 13
1-5/16"	1.312 .312 x .156	326642 - 14
1-3/8"	1.375 .312 x .156	326642 - 15
1-7/16"	1.437 .375 x .187	326642 - 16
1-1/2"	1.500 .375 x .187	326642 - 17
1-9/16"	1.562 .375 x .187	326642 - 18
1-5/8"	1.625 .375 x .187	326642 - 19

## Technical Data and Torque (In. Lb.)

Model No.	Wt. Lbs.	Static Torque in. lb.	Max. Speed RPM	Coil Voltage vdc	*Rated Current amps	RPM									
						0	300	600	900	1200	1500	1800	2400	3000	3600
<b>308</b>	14.2	2100	3600	90	.57	2100	1848	1596	1428	1344	1260	1128	888	720	588

\* Rated Current for 90v.

Refer to Section M for torque and heat dissipation curves. Customer must maintain concentricity between shafts within .010.

## Order Parts for Assembly No. FC308158-3

	Armature Hub	Armature Plate Assembly	(1615) Taper Bushing	Bearing Mounted Rotor & Field	(1610) Taper Bushing
24 Volts	308680	308382-4	326015-XX	308773	326642-XX
90 Volts	308680	308382-4	326015-XX	308774	326642-XX

To order, specify: 1, Armature Hub 1, Armature Plate Assembly  
 1, Taper Bushing (1615) of required Bore size 1, Taper Bushing (1610) of required Bore size  
 1, Bearing Mounted Rotor and Field of required Voltage

For controls, see Section K.

# Clutch Coupling – Replacement Parts

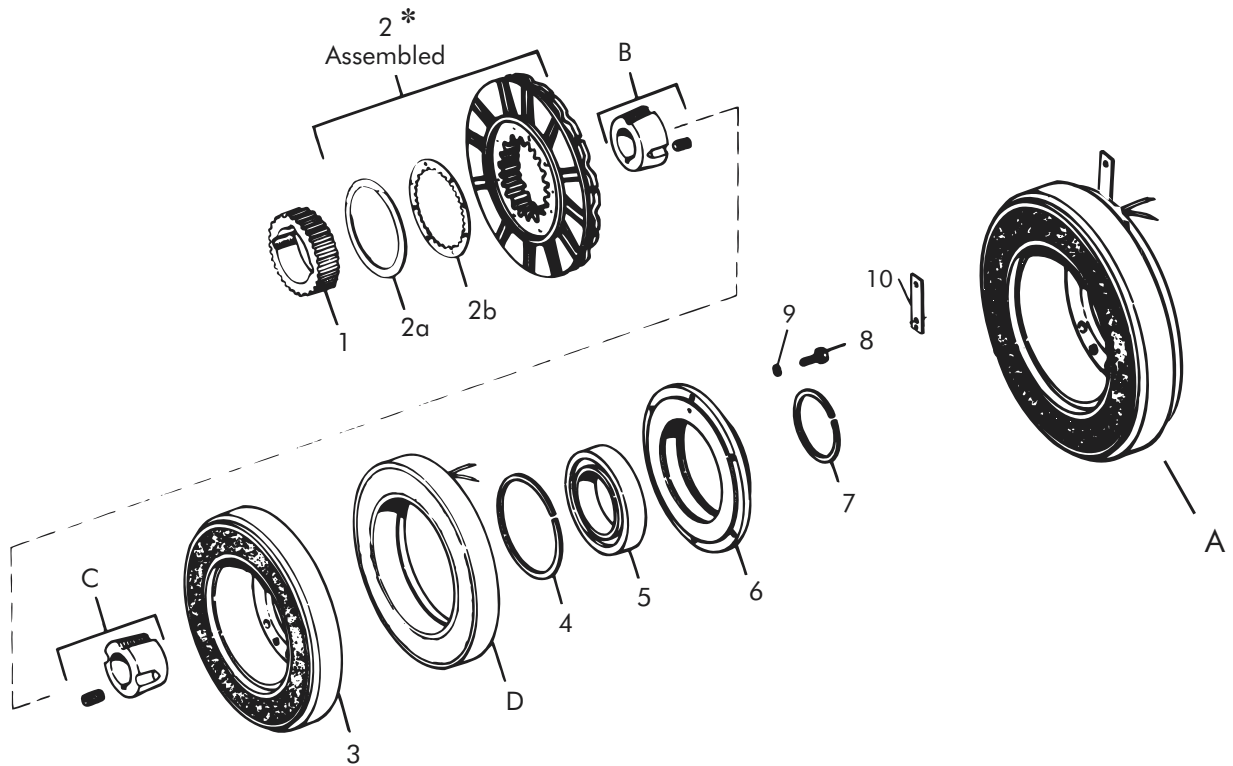

## Replacement Parts

Item	Qty.	Description	Part No.	Item	Qty.	Description	Part No.
1	1	Armature Hub	308680	A	1	Rotor and Field	
2	1	Armature Plate Assy. (27 Teeth)	308382-4			24 Volts	308773
2a	1	Ajusto-gap® Spring	326273			90 Volts	308774
2b	1	Drag Spring	326276	B	1	Taper Bushing (1615)	326015-XX
3	1	Rotor Assembly	308820-8	C	1	Taper Bushing (1610)	326642-XX
4	1	Retaining Ring (Internal)	RY-20042	D	1	Field	
5	1	Bearing	RY-20047			24 Volts	308733-4
6	1	Field Mounting Hub	308752			90 Volts	308734-4
7	1	Retaining Ring (External)	RY-20037				
8	6	Screw	DY-14764				
9	6	Washers	DY-4366				
10	1	Support Arm	326549				
11	1	Pin (not shown)	RY-20094				

\* Current design armatures are solid.