

Clutch-Brake Coupling

Model
● 310

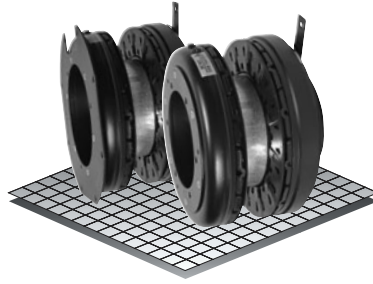

- ▶ Stationary Field
- ▶ Bearing Mounted
- ▶ Pin Drive

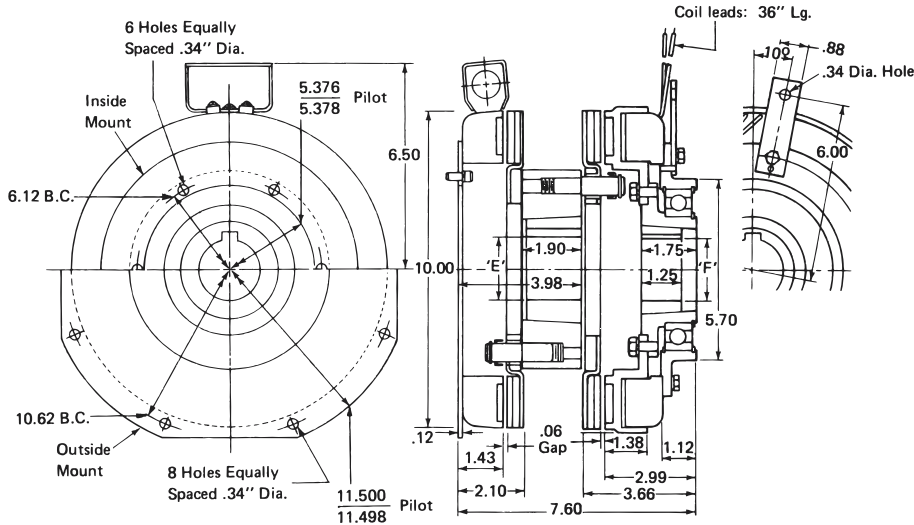

Technical Data and Torque (In. Lb.)

Model No.	Wt. Lbs.	Static Torque in. lb.	Max. Speed RPM	Coil Voltage vdc	* Rated Current amps	RPM							
						0	300	600	900	1200	1500	1800	2400
310	65.0	3600	2400	90	.60	3600	3144	2616	2088	1788	1596	1416	1044

* Rated current at 90v.

Customer must maintain:

1. Concentricity between mounting flange and shaft within .010.
2. Perpendicularity between mounting surface and shaft within .010.

Refer to Section M for torque and heat dissipation curves.

Bushing 2517

Bore "E"		Keyway	Part No.
1/2"	.500	.125 x .062	326039 - 1
9/16"	.562	.125 x .062	326039 - 2
5/8"	.625	.187 x .093	326039 - 3
11/16"	.687	.187 x .093	326039 - 4
3/4"	.750	.187 x .093	326039 - 5
13/16"	.812	.187 x .093	326039 - 6
7/8"	.875	.187 x .093	326039 - 7
15/16"	.937	.250 x .125	326039 - 8
1"	1.000	.250 x .125	326039 - 9
1-1/16"	1.062	.250 x .125	326039 - 10
1-1/8"	1.125	.250 x .125	326039 - 11
1-3/16"	1.187	.250 x .125	326039 - 12
1-1/4"	1.250	.250 x .125	326039 - 13
1-5/16"	1.312	.312 x .156	326039 - 14
1-3/8"	1.375	.312 x .156	326039 - 15
1-7/16"	1.437	.375 x .187	326039 - 16
1-1/2"	1.500	.375 x .187	326039 - 17
1-9/16"	1.562	.375 x .187	326039 - 18
1-5/8"	1.625	.375 x .187	326039 - 19
1-11/16"	1.687	.375 x .187	326039 - 20
1-3/4"	1.750	.375 x .187	326039 - 21
1-13/16"	1.812	.500 x .250	326039 - 22
1-7/8"	1.875	.500 x .250	326039 - 23
1-15/16"	1.937	.500 x .250	326039 - 24
2"	2.000	.500 x .250	326039 - 25
2-1/16"	2.062	.500 x .250	326039 - 26
2-1/8"	2.125	.500 x .250	326039 - 27
2-3/16"	2.187	.500 x .250	326039 - 28
2-1/4"	2.250	.500 x .250	326039 - 29
2-5/16"	2.312	.625 x .187	326039 - 30
2-3/8"	2.375	.625 x .187	326039 - 31
2-7/16"	2.437	.625 x .187	326039 - 32
2-1/2"	2.500	.625 x .187	326039 - 33

Bushing 2012

Bore "F"		Keyway	Part No.
1/2"	.500	.125 x .062	326167 - 8
9/16"	.562	.125 x .062	326167 - 9
5/8"	.625	.187 x .093	326167 - 10
11/16"	.687	.187 x .093	326167 - 11
3/4"	.750	.187 x .093	326167 - 12
13/16"	.812	.187 x .093	326167 - 13
7/8"	.875	.187 x .093	326167 - 14
15/16"	.937	.250 x .125	326167 - 15
1"	1.000	.250 x .125	326167 - 16
1-1/16"	1.062	.250 x .125	326167 - 17
1-1/8"	1.125	.250 x .125	326167 - 18
1-3/16"	1.187	.250 x .125	326167 - 19
1-1/4"	1.250	.250 x .125	326167 - 7
1-5/16"	1.312	.312 x .156	326167 - 20
1-3/8"	1.375	.312 x .156	326167 - 6
1-7/16"	1.437	.375 x .187	326167 - 21
1-1/2"	1.500	.375 x .187	326167 - 1
1-9/16"	1.562	.375 x .187	326167 - 22
1-5/8"	1.625	.375 x .187	326167 - 2
1-11/16"	1.687	.375 x .187	326167 - 23
1-3/4"	1.750	.375 x .187	326167 - 3
1-13/16"	1.812	.500 x .250	326167 - 24
1-7/8"	1.875	.500 x .250	326167 - 4
1-15/16"	1.937	.500 x .187	326167 - 25
2"	2.000	.500 x .187	326167 - 5

Order Parts for Assembly No. FC310166 and FC310167

	Magnet Accessory	Armature Plate Assembly	Armature Hub	Magnet	Bearing Mounted Rotor & Field	(2517) Taper Bushing	(2012) Taper Bushing	FC310166		Ajusto-gap® Accessory
								FC310167		
								Mounting Plate w/accy	Mounting Plate w/accy	
24 Volts	326078	310380	310450	310373	310773	326039-XX	326167-XX	310481	310491	326075
90 Volts	326078	310380	310450	310374	310774	326039-XX	326167-XX	310481	310491	326075

To order, specify:

1, Mounting Plate w/Accessory for either Inside Mount or Outside Mount	2, Ajusto-gap® Accessories
1, Magnet Accessory	1, Armature Hub Assembly
2, Armature Plate Assemblies	1, Bearing Mounted Rotor & Field of required Voltage
1, Magnet of required Voltage	1, Taper Bushing (2012) of required Bore size
1, Taper Bushing (2517) of required Bore size	

For controls, see Section K.

Clutch-Brake Coupling – Replacement Parts

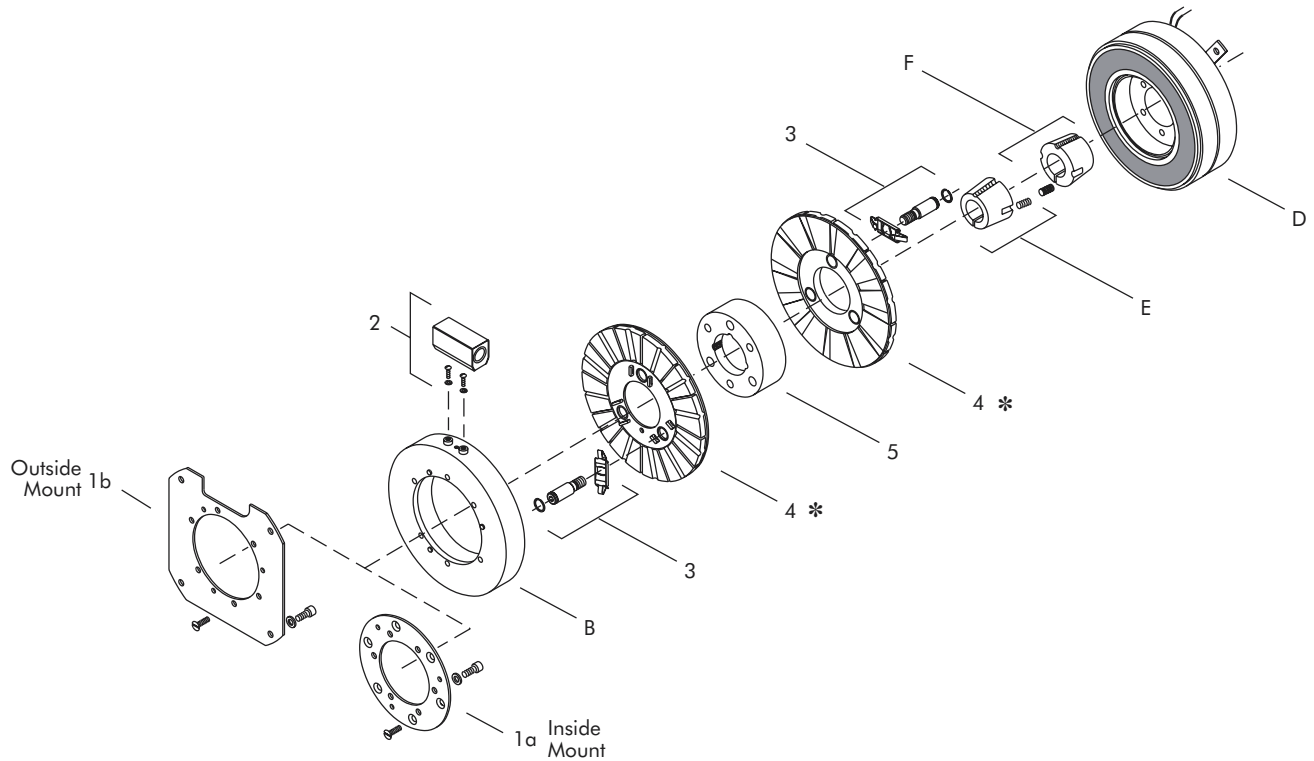

Replacement Parts

Item	Qty.	Description	Part No.	Item	Qty.	Description	Part No.
1	1	Mounting Plate w/Accessory		D	1	Bearing Mounted Rotor & Field	
1a		Inside Mount	310481			24 Volts	310773
1b		Outside Mount	310491			90 Volts	310774
2	1	Brake Magnet Accessory	326078	E	1	Taper Bushing (2517)	326039-XX
3	2	Ajusto-gap® Accessory	326075	F	1	Taper Bushing (2012)	326167-XX
4	2	Armature Plate Assembly	310380				
5	1	Armature Hub	310450				
B	1	Magnet					
		24 Volts	310373				
		90 Volts	310374				

* Current design armatures are solid.